



250 WEST PRATT

A STEP ABOVE

250 W. PRATT STREET BALTIMORE, MD 21202

OWNED & MANAGED BY

 **COPT DEFENSE**
PROPERTIES

 **CUSHMAN & WAKEFIELD**

BALTIMORE BEACON

Make more of every day at 250 West Pratt, an iconic Inner Harbor workspace offering direct access to I-395, Light Rail, and the **MARC Train** at the gateway to downtown Baltimore.

Defining the Charm City skyline, 250 West Pratt pairs an all-inclusive amenity mix with a chart-topping location steps from Camden Yards, the Baltimore Convention Center, dining hotspots, and harborfront entertainment. Fuel up with a coffee from Baltimore Brewhouse, work in a workout from a trophy-class fitness center, and stay in sync with the city from vibrant terraces and conference space framing panoramic views. Impactfully anchored by an activated outdoor plaza and a sleek lobby lounge showcasing a living LED screen, 250 West Pratt gives you more to work with.

WELCOMING



Class A Office



360,000 SF



24 stories



650 car parking garage behind the building



Brand new on-site amenities



Numerous nearby hotels, restaurants, and convention center

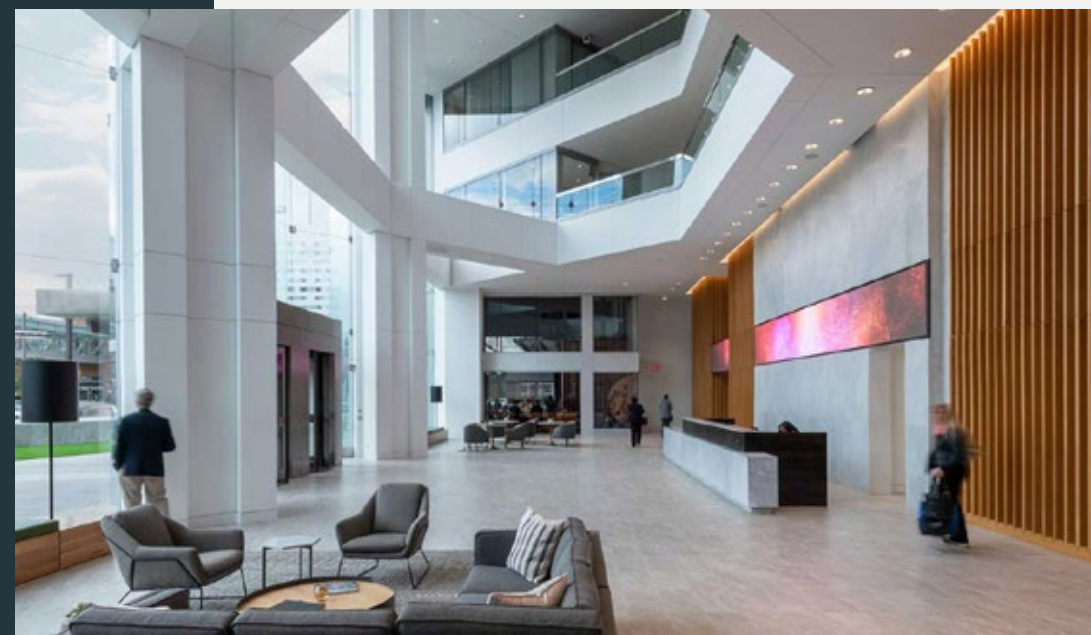
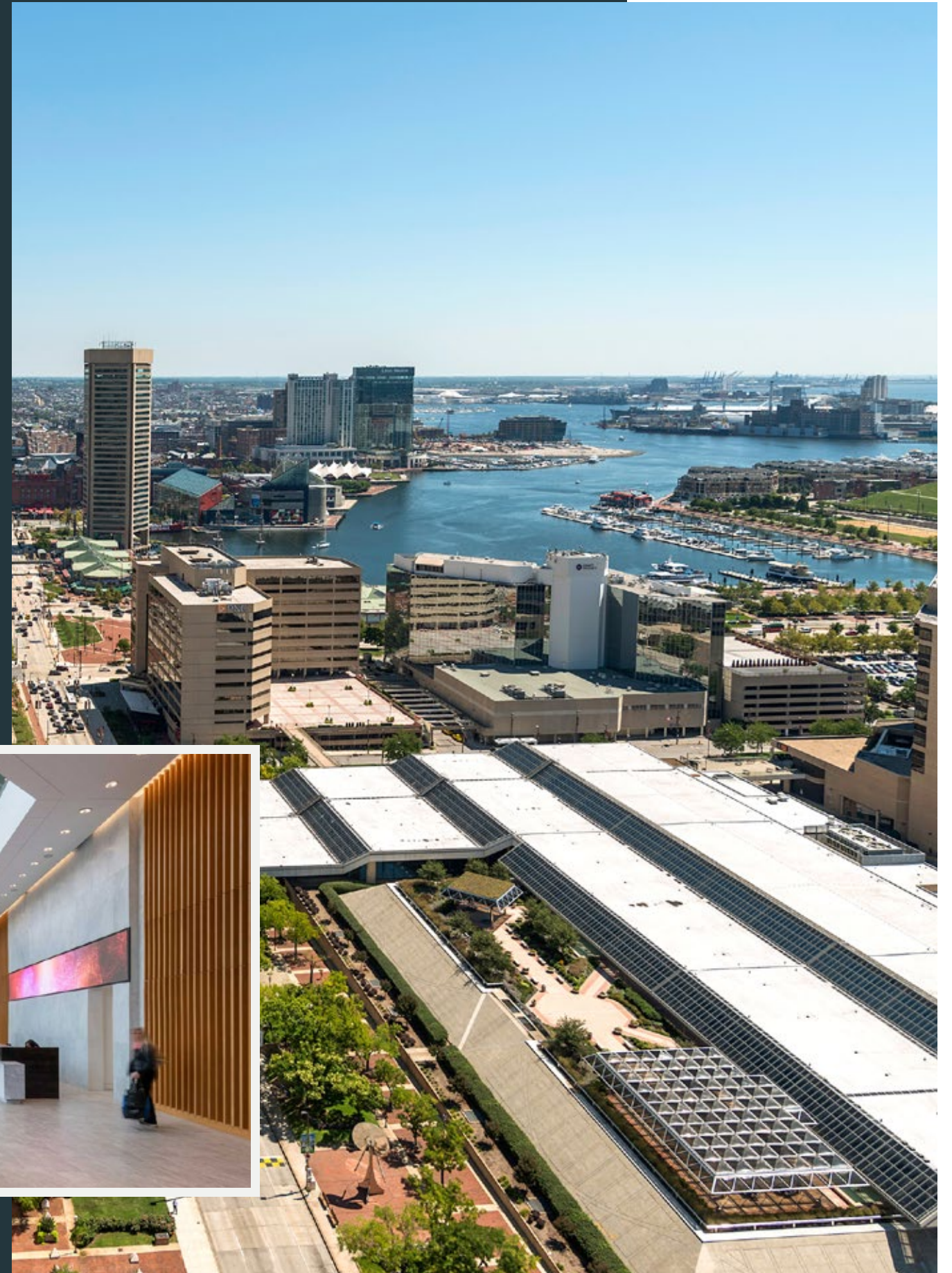

NEW AMENITIES

MORE TO WORK WITH

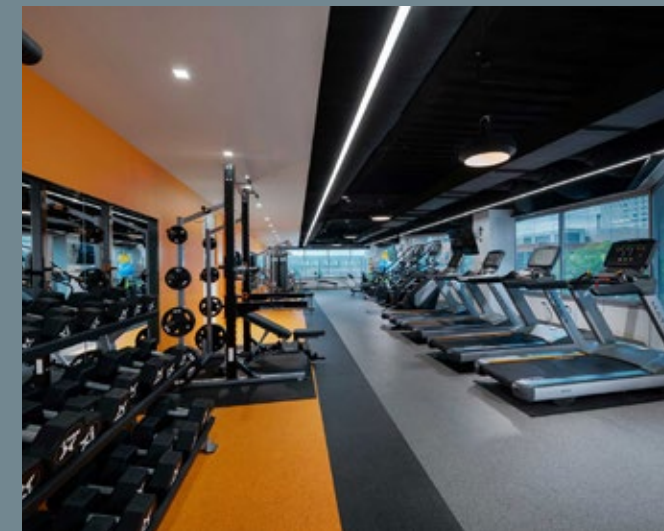
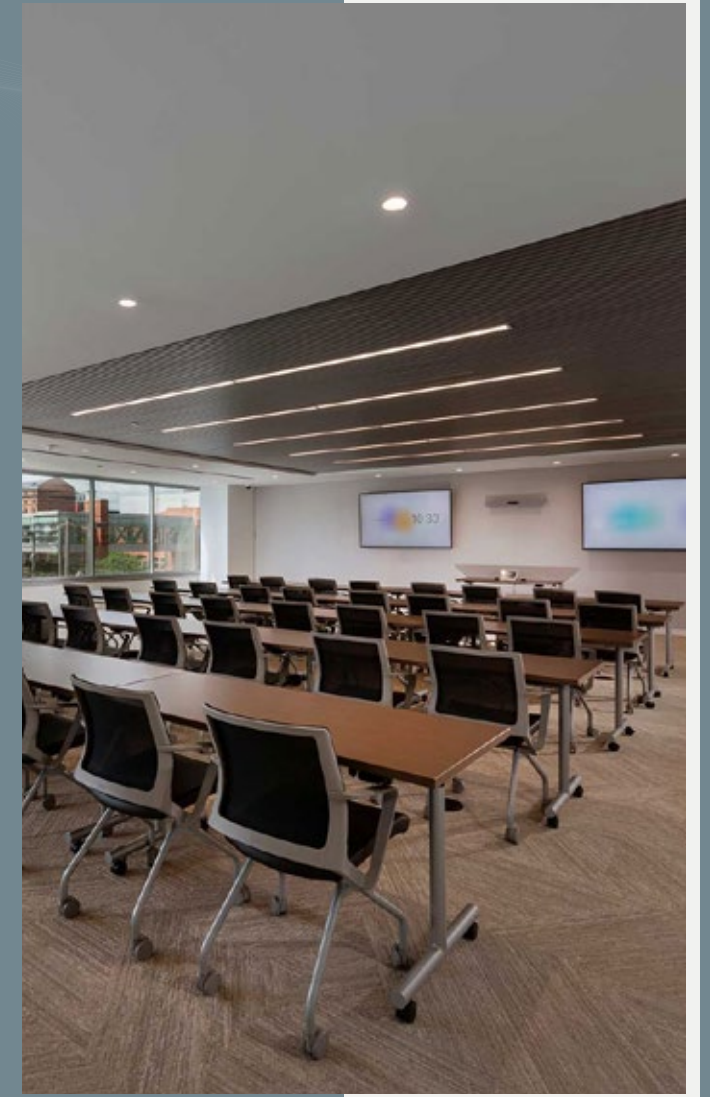
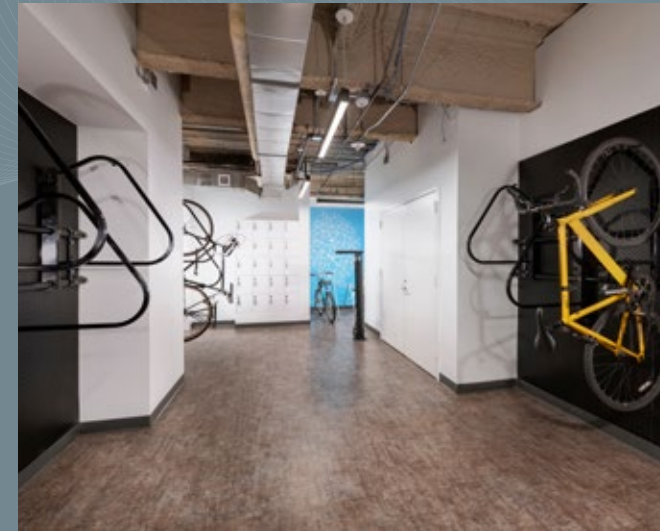

- Revitalized plaza
- Extensive lobby renovations
- Conference center
- Fitness center

- SECU Bank
- Living LED screen in lobby lounge
- Indoor bike storage

INCLINED TO EXCEL

MAKE YOUR MARK

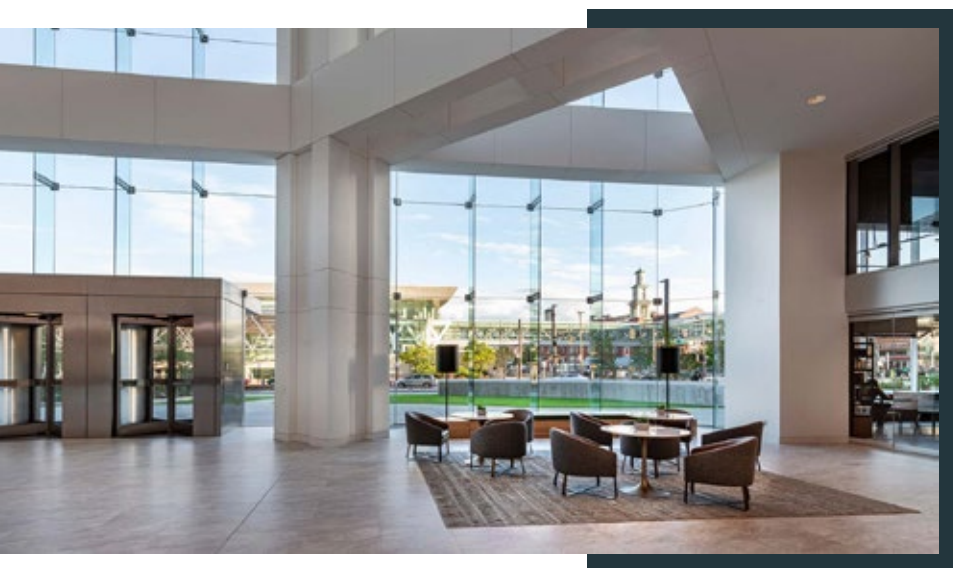
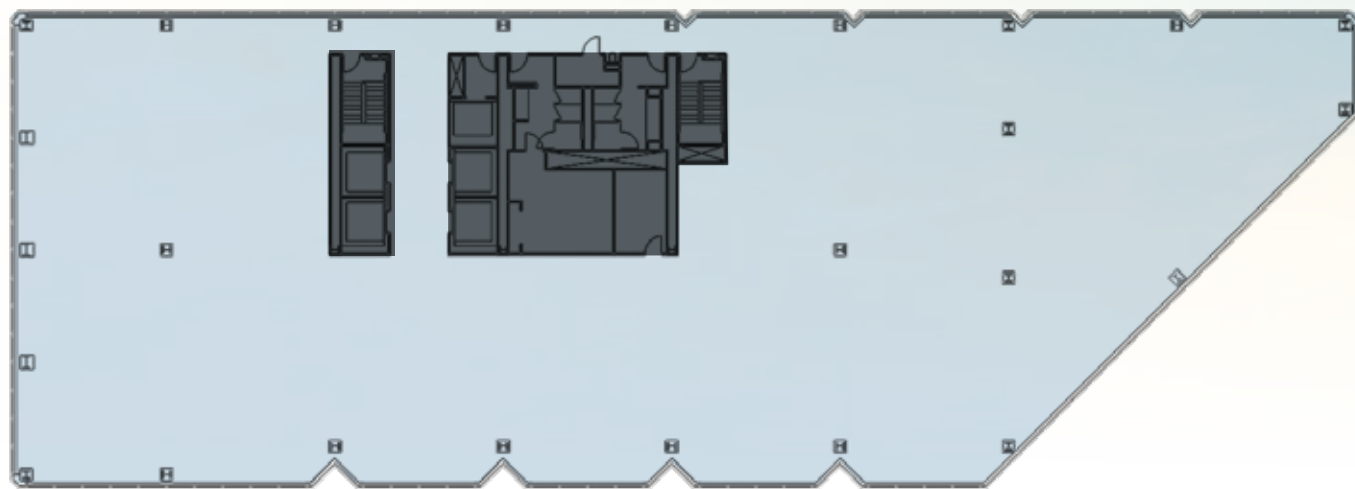

VIEW AVAILABILITY

D O M O R E .
S E E M O R E .
B E M O R E .



250 WEST PRATT



HARBORSIDE DINING

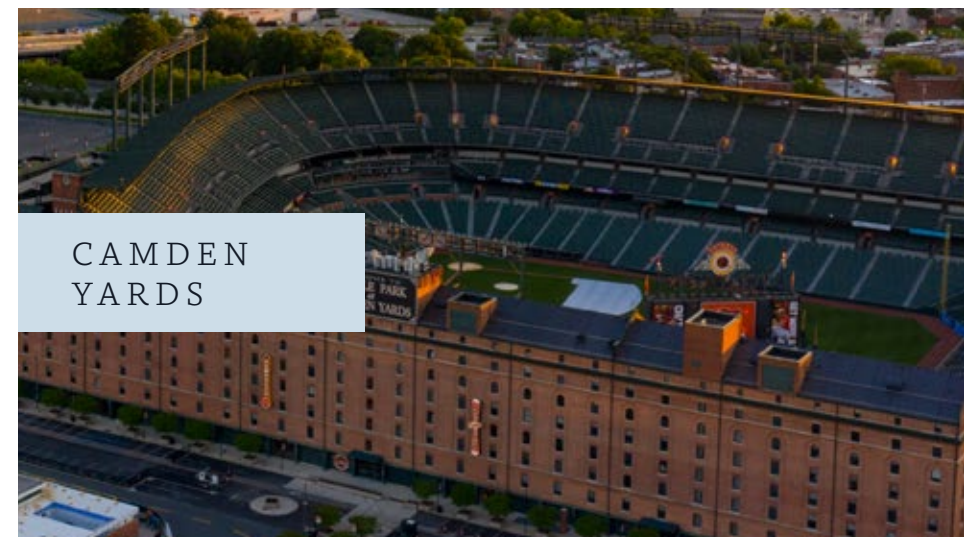

CAMDEN YARDS



HAPPY HOUR /NIGHTLIFE

- | | | | | | |
|---------------------------------|-----------------------------|--------------------|---|---|---|
| 1 Sheraton Inner Harbor | 8 Days Inn | 15 PNC Bank | 20 One East Pratt: Kona Grill, Sullivan's, Filicori | 26 Morton's Steakhouse | 31 Power Plant Live: Ruth's Chris Steak House MEX, Rams Head Tavern |
| 2 Hyatt Regency | 9 Holiday Inn | 16 Bank of America | 21 Chipotle | 27 Brio | 32 Power Plant: Phillips Seafood, Pot Belly, Hard Rock Café, Blu Bambu Chipotle |
| 3 Royal Sonesta Harbor Court | 10 Marriott at Camden Yards | 17 M&T Bank | 22 Jimmy Johns | 28 Light Street Pavilion | 33 Rusty Scupper |
| 4 Marriott Residence Inn | 11 Hilton | 18 Wells Fargo | 23 Pratt Street Ale House | 29 Pratt Street Pavilion: Cheesecake Factory, Uno Pizzeria, M&S Grill, Five Guys, Edo Sushi, Tir Na Nog, La Tasca | 34 Baltimore Brewhouse |
| 5 Brookshire Suites | 12 Hampton Inn | 19 BB&T Bank | 24 DSX Restaurant and Sports | 30 Lockwood Place: The Capital Grille, Corner Bakery, PF Chang's, Fogo de Chao, IHOP | |
| 6 Renaissance Harborplace Hotel | 13 Pier 6 Ascend | | | | |
| 7 Radisson Plaza Lord Baltimore | 14 Marriott Waterfront | | | | |

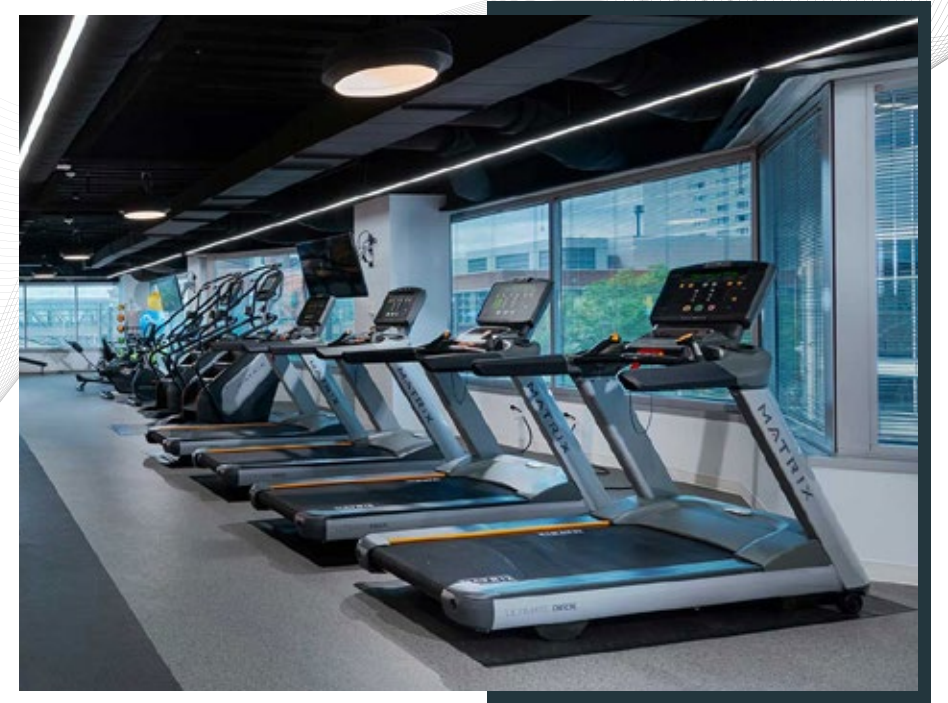

WORK LIKE A CHARM

ALL-ACCESS INNER HARBOR OFFICE SPACE

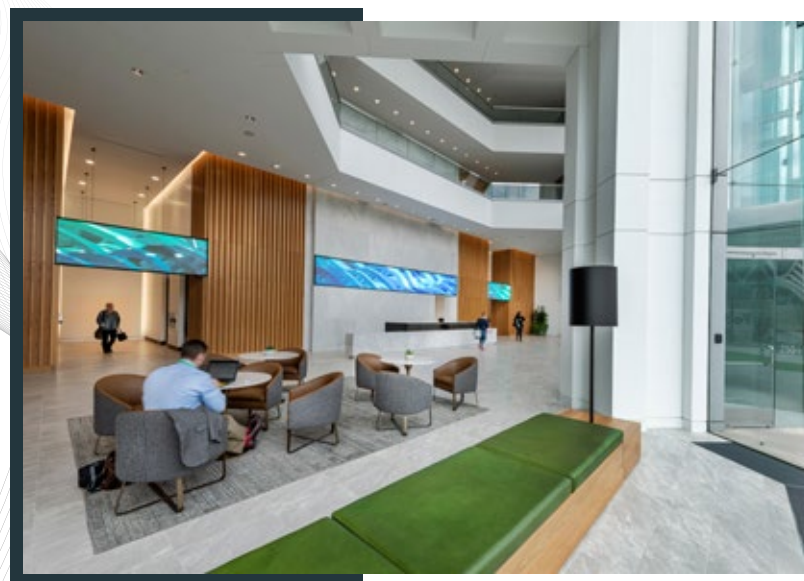

- **8:30 AM /**
GET YOUR COFFEE FIX FROM BALTIMORE BREWHOUSE
- **10:00 AM /**
TAKE A MID-MORNING WALK AND SIP A CAFÉ ON THE ACTIVATED OUTDOOR PLAZA
- **12:00 NOON /**
ENJOY LUNCH IN THE SLEEK LOBBY WITH ITS LIVING LED SCREEN

- **2:30 PM /**
WORKOUT IN TROPHY-CLASS FITNESS CENTER

- **6:30 PM /**
HAVE DINNER AROUND THE HARBOR

- **8:00 PM /**
TAKE IN THE BREATHTAKING INNER HARBOR VIEWS

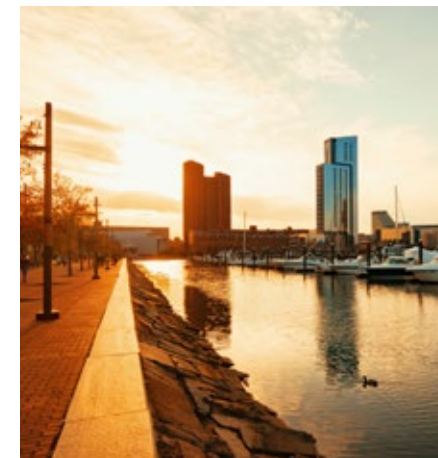



250 WEST
PRATT

A S T E P
A B O V E .

Schedule a Tour Today.

Tim Jackson
Managing Director
+1 410 591 7379
tim.jackson@cushwake.com

Courtenay Jenkins
Executive Director
+1 410 685 9590
court.jenkins@cushwake.com

OWNED & MANAGED BY



©2023 Cushman & Wakefield. All rights reserved. The information contained in this communication is strictly confidential. This information has been obtained from sources believed to be reliable but has not been verified. NO WARRANTY OR REPRESENTATION, EXPRESS OR IMPLIED, IS MADE AS TO THE CONDITION OF THE PROPERTY (OR PROPERTIES) REFERENCED HEREIN OR AS TO THE ACCURACY OR COMPLETENESS OF THE INFORMATION CONTAINED HEREIN, AND SAME IS SUBMITTED SUBJECT TO ERRORS, OMISSIONS, CHANGE OF PRICE, RENTAL OR OTHER CONDITIONS, WITHDRAWAL WITHOUT NOTICE, AND TO ANY SPECIAL LISTING CONDITIONS IMPOSED BY THE PROPERTY OWNER(S). ANY PROJECTIONS, OPINIONS OR ESTIMATES ARE SUBJECT TO UNCERTAINTY AND DO NOT SIGNIFY CURRENT OR FUTURE PROPERTY PERFORMANCE.